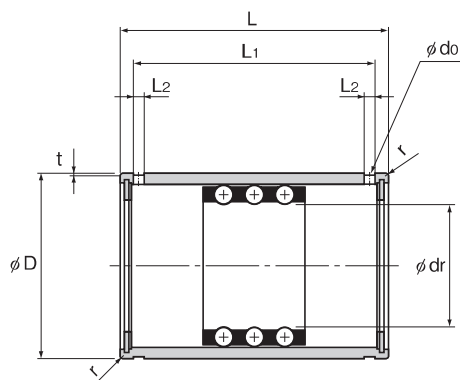
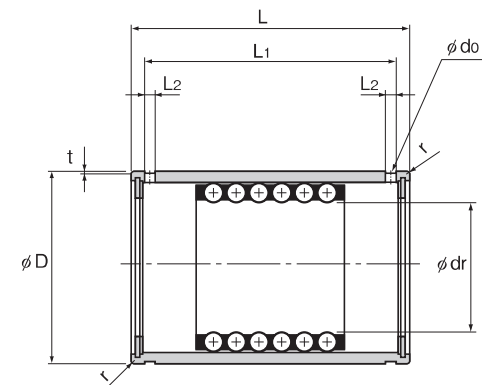

ST形、ST-B形

ST形
(軽荷重用)ST-B形
(中荷重用)

単位:mm

呼び形番	最大ストローク	内接円径		外径		長さ					基本動 定格荷重 C kN	基本静 定格荷重 C ₀ kN	質量 g		
		dr	許容差	D	許容差	L	許容差	L ₁	L ₂	t				d ₀	r
ST 40 ST 40B	108 66	40	+0.041 +0.025	60	0 -0.013	80	0 -0.3	73.3	2.5	0.7	2.5	1.5	12.5 25	6.18 12.4	570 635
ST 45 ST 45B	108 66	45		65		80		73.3	2.5	0.7	2.5	1.5	12.6 25.2	6.76 13.5	625 695
ST 50 ST 50B	138 88	50		72		100		92.4	3	1	3	1.5	16.3 32.5	8.82 17.7	910 1020
ST 55 ST 55B	138 88	55		80		100		92.4	3	1	3	2	16.6 33	9.71 19.3	1270 1380
ST 60 ST 60B	138 88	60	+0.049 +0.030	85	0 -0.015	100	0 -0.4	92.4	3	1	3	2	16.8 33.6	10.5 21	1360 1480
ST 70 ST 70B	138 88	70		95		100		92.4	3	1	3	2	16.9 33.8	11.7 23.3	1530 1670
ST 80 ST 80B	132 76	80		110		100		92	3	1.5	3	2	21.3 42.5	15.3 30.6	2220 2430
ST 90 ST 90B	132 76	90	+0.058 +0.036	120	0 -0.018	100	0 -0.4	92	3	1.5	3	2	21.7 43.3	16.9 33.7	2440 2670
ST 100 ST 100B	132 76	100		130		100		92	3	1.5	3	2	22 43.9	18.3 36.8	2670 2910